

## 快速安装指南

P2EXP

www.flyingvoice.cn

初次设置请仔细阅读安装指南，并按相应步骤进行配置。如需更换网络环境或账号，可修改相应配置。每次配置修改后必须保存、重启方可生效。更多使用方法，请前往我司官方网站（www.flyingvoice.cn）下载相应产品的用户手册。

### 1 检验包装

请检查您购买的产品是否包含下面组成部件，若缺少请与您的经销商联系。



### 2 硬件介绍

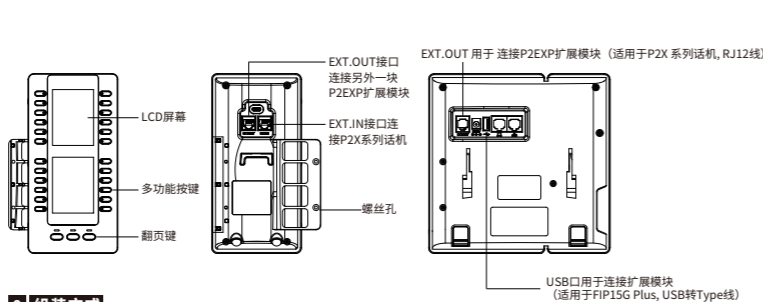

### 3 组装方式

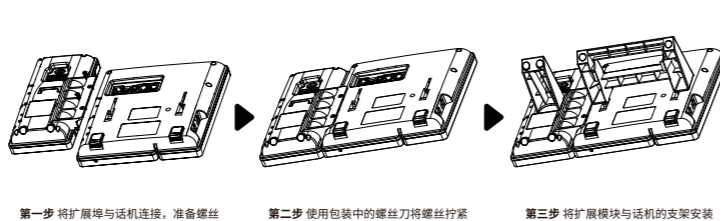

### 4 连接P2EXP扩展模块

#### 1、通过EXT.OUT扩展口 进行连接（适用于P2X系列IP话机，双头RJ12线）

用RJ12连接线将P2X IP话机的EXT.OUT接口与第一个模块的EXT.IN接口连接。如果要连接另一个模块，请使用RJ12连接线将第一个模块的EXT.OUT和第二个模块的EXT.IN连接。

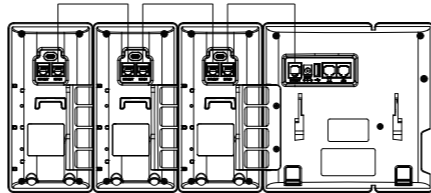

#### 2、通过USB接口进行连接（适用于FIP15G Plus IP话机，USB转Type线）

方式一：通过USB转TypeC线连接扩展模块（该方式仅支持连接一个扩展模块）

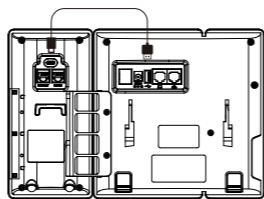

方式二：话机USB口连接USB Hub（独立供电的扩展坞，需另外购买），将扩展模块1、2、3依次通过USB转Type-C线连接。

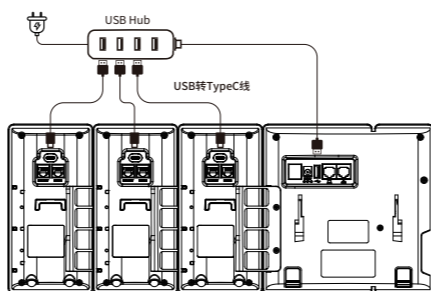

### 5 LED指示灯

#### 翻页键LED灯

LED状态	描述
绿色常亮	当前页面
熄灭	非当前页面
红色快闪	非当前页面上BLF监控的用户有来电

#### 扩展键LED灯（配置为账号功能）

LED状态	描述
绿色常亮	账号正在通话中
红色快闪	账号收到来电
红色慢闪	通话被保持
熄灭	账号处于空闲状态

#### 扩展键LED灯（配置为BLF功能）

LED状态	描述
绿色常亮	被监控用户处于空闲状态
红色快闪	被监控用户收到来电
红色常亮	被监控的用户正在说话 被监控的用户的话处于保持状态 被监控的用户正在拨号。
熄灭	被监控用户不存在

### 6 基础设置

P2EXP 在三个屏幕页面中支持 72 个 DSS 键。每页显示 24 个 DSS 键。您可以按翻页键切换到相应的页面并使用您想要的 DSS 键。您可以通过话机界面为 DSS 键分配功能。按住P2EXP所需的DSS键约3秒，话机液晶屏会提示该键的设置。以下章节为您提供通过网页界面将一些常用功能分配给 DSS 键的详细说明。

#### 速拨

您可以通过按快速拨号键来快速拨打常用的号码。

1. 点击**电话->扩展键**。
2. 选择所需的扩展键，从类型中选择**快速拨号**。
3. 选择您想要使用拨出的账号。
4. 在**值**中输入想要直接拨出的速拨号码，（可选）填写**标签**。
5. 点击保存并应用。

### BLF

通过BLF键可以监控预定义号码的状态。您还可以接听被监听号码的来电。

1. 点击**电话->扩展键**。
2. 选择所需的扩展键，在类型中选择“BLF”。
3. 选择你想要用于监听的账号。
4. 在**值**中输入想要监听的BLF号码，（可选）填写**标签**。
5. 在分机中输入指定的载答码。
5. 点击保存并应用。

### 账号

您可以将扩展键设置为账号，便于使用该线路进行拨号呼叫。

1. 点击**电话->扩展键**。
2. 选择所需的扩展键，在类型中选择账号，（可选）填写**标签**。
3. 点击保存并应用。

### 对讲机

您可以将扩展键设置为对讲，便于办公环境中更快的通知接线员或秘书。

1. 点击**电话->扩展键**。
2. 选择所需的扩展键，在类型中选择对讲机。
3. 选择您想要使用拨出的**账号**。
4. 在**值**中输入想要对讲的终端号码，（可选）填写**标签**。
5. 点击保存并应用。

### 7 恢复出厂设置

- 第一步 登录连接的主机网页，进入**话机->扩展键**，选择需要清空的扩展板页面。
- 第二步 点击 恢复出厂设置，即可将当前扩展板页面的所有设置清空。若要将其他页面清除，重复此步骤。

If you are installing the device for the first time, please read this manual in advance and configure it step by step. Reboot the device once you finish the configuration is required, including change the network environments, account number and so on. If you need more info, please go to our website (www.flyingvoice.com) and download the user manual.

## 1 Packaging List

The following items are included in your package. If you find anything missing, contact your system

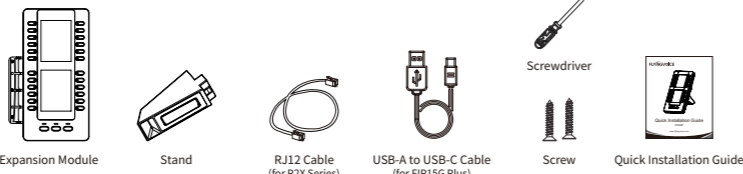

## 2 Assembling the Phone

Refer to the following illustration to assemble the handset:

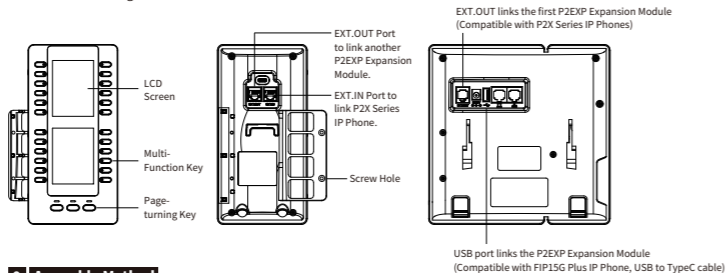

## 3 Assembly Method

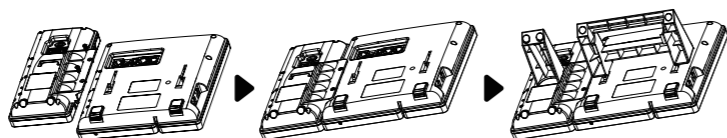

Step 1 Connect the expansion module to the phone and prepare the screws.

Step 2 Tighten the screws using the screwdriver supplied in the package.

Step 3 Mount the expansion module and the phone's stand

## 4 Connect P2EXP Expansion Module

### 1. Connection P2EXP via EXT.OUT Port (Compatible with P2X Series IP Phones, RJ12 cable)

Connect the **EXT.OUT** port of the P2X IP Phone to the **EXT.IN** port of the first P2EXP module using the RJ12 cable. To connect the second module, use the RJ12 cable to connect the **EXT.OUT** port of the first module to the **EXT.IN** port of the second module.

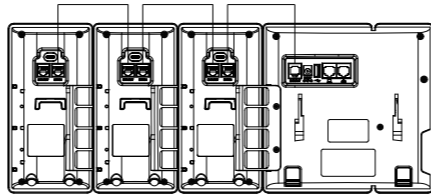

### 2. Connecting P2EXP via USB Port (Compatible with FIP15G Plus IP Phone, USB to TypeC cable)

**Method 1:** Connect the USB port on the host phone and the Type-C port on the expansion module using one supplied cable. (This way supports the connection of only one expansion module)

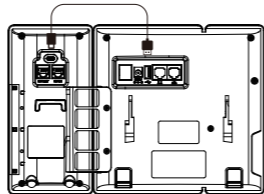

**Method 2:** Connect three expansion modules, the IP Phone must be connected to a USB hub (with independent power supply). Then, expansion modules 1/2/3 should be connected to the USB hub individually.

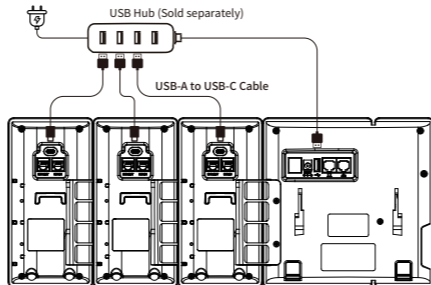

## 5 LED Instructions

### Page Key LED

LED Status	Description
Solid green	Current page.
Fast-flashing red	The BLFmonitored user receives an incoming call on the non-currentpage.
Off	Non-current page.

### Ext Key LED (configured as a Line key)

LED Status	Description
Solid green	The line is in conversation.
Fast-flashing red	The line receives an incoming call.
Slow-flashing red	The call is placed on hold.
Off	The line is inactive.

### Ext Key LED (configured as a BLF key)

LED Status	Description
Solid green	The monitoreduseris idle.
Fast-flashing red	The monitored user receives an incoming call.
Solid red	The monitored user is talking. The monitored user' s conversation is placed on hold. The monitored user is dialing. The call is parked against the monitored user' s phone number.
Off	The monitored user does not exist.

## 6 Basic Settings

The P2EXP supports 72 DSS keys in three screen pages. Each page displays 24 DSS keys. You can press **Page-turning key** to switch to the corresponding page and use your desired DSS key. You can assign a feature to a DSS key via phone user interface. Press the desired DSS key of P2EXP for about 3 seconds, the phone LCD screen will prompt the setting of this key. The following sections provide you with detailed instruction of assigning some frequently used features to the DSS keys via web user interface.

### Speed Dial

You can speed up dialing the frequently used numbers by pressing the speed dial key.

1. Navigate to **Phone->Ext Key**.
2. Select the desired Ext key, select **SpeedDial** from the **Type**.
3. Select the desire **Line** from the **Line**.
4. Enter the desired number you want to dial out directly in the **Value** field, (optional) enter the **Label**.
5. Click **Save & Apply**.

### BLF

The BLF key allows you to monitor the status of the pre-defined extension. You can also pick up incoming calls of the monitored extension.

1. Navigate to **Phone->Ext Key**.
2. Select the desired Ext key, select **BLF** from the **Type**.
3. Enter the phone number or extension you want to monitor in the **Value** field, enter the **Label**.
4. Enter the directed call pickup code in the **Extension** field.
5. Click **Save & Apply**.

### Line

You can configure a DSS key as the line key.

1. Navigate to **Phone->Ext Key**.
2. Select the desired Ext key, select the desired **Line** from the **Type**.
3. (Optional) enter the **Label**.
4. Click **Save & Apply**.

### Intercom

You can connect to the operator or the secretary more quickly by pressing the intercom key in an office environment .

1. Navigate to **Phone->Ext Key**.
2. Select the desired Ext key, select **Intercom** from the **Type**.
3. Select the desired line from the **Line**.
4. Enter the remote extension number in the **Value** field, (Optional) enter the **Label**.
5. Click **Save & Apply**.

## 7 Factory Default

**Step 1** Log in to the Web GUI of IP Phone, navigate to **Phone->Ext Key**, and select the extension module page that needs to be cleared.

**Step 2** Click **Restore Factory Settings** to clear all settings of the current expansion board page. To clear other pages, repeat this step.

# Quick Installation Guide

P2EXP

www.flyingvoice.com